



# PHASE 1

## FLOOR PLANS

Site & Sales: Opp. Padle Gaon Bus Stop, Off Kalyan-Shil Road, Thane - 421204  
T:7677501501 / 7304435577 | W: [marathon.in/nextown](https://marathon.in/nextown)



The project has been registered via MahaRERA registration number: RERA NO.: P51700000686/0952/1265/P51700049449/P51700021189 and is available on the website <https://maharera.mahaonline.gov.in> under registered projects.





# THE TOWNSHIP

Spread across a vast expanse of lush green freehold land, Nextown provides one of the best integrated township living experiences in all of Kalyn-Shil.

\*The Layout Plan is for representational purposes only & are not according to scale



## Typical Floor Plan

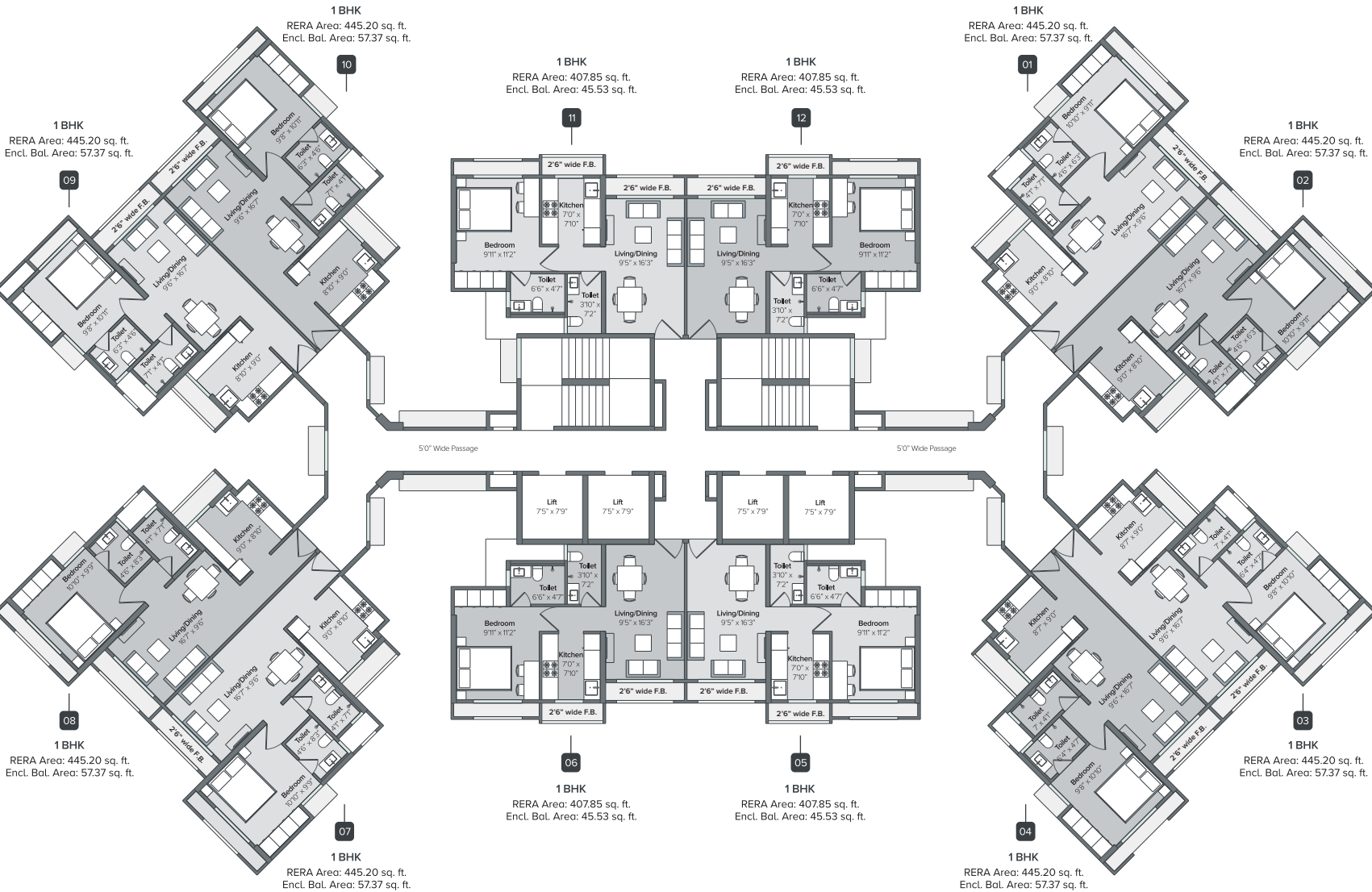

Flat number 12 on the 12th floor.

## Typical Floor Plan

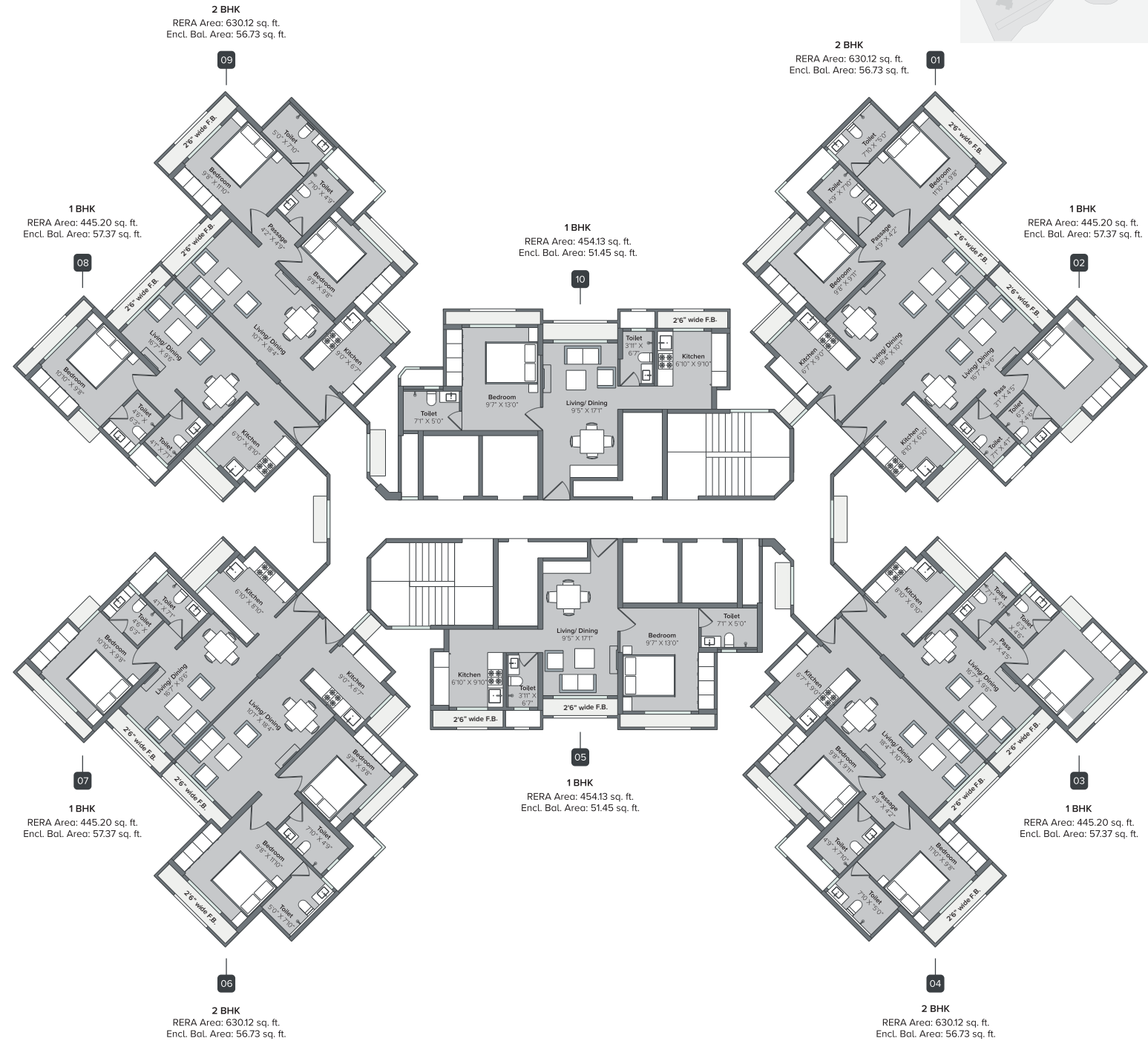

Disclaimer: The floor plans are as per the approved plans and specifications as of date. These plans may vary by +/- 3% and are subject to changes. The furniture, accessories, etc. shown in the plans does not form a part of the offering. Customers are requested to visit the site office and apprise themselves of all the necessary details prior to making any purchase decisions.

Floors 9 & 12 are refuge floors and flat number 9 on each of these floors are not available for sale.

Emerald  
1st to 19th Floor  
Typical Floor Plan

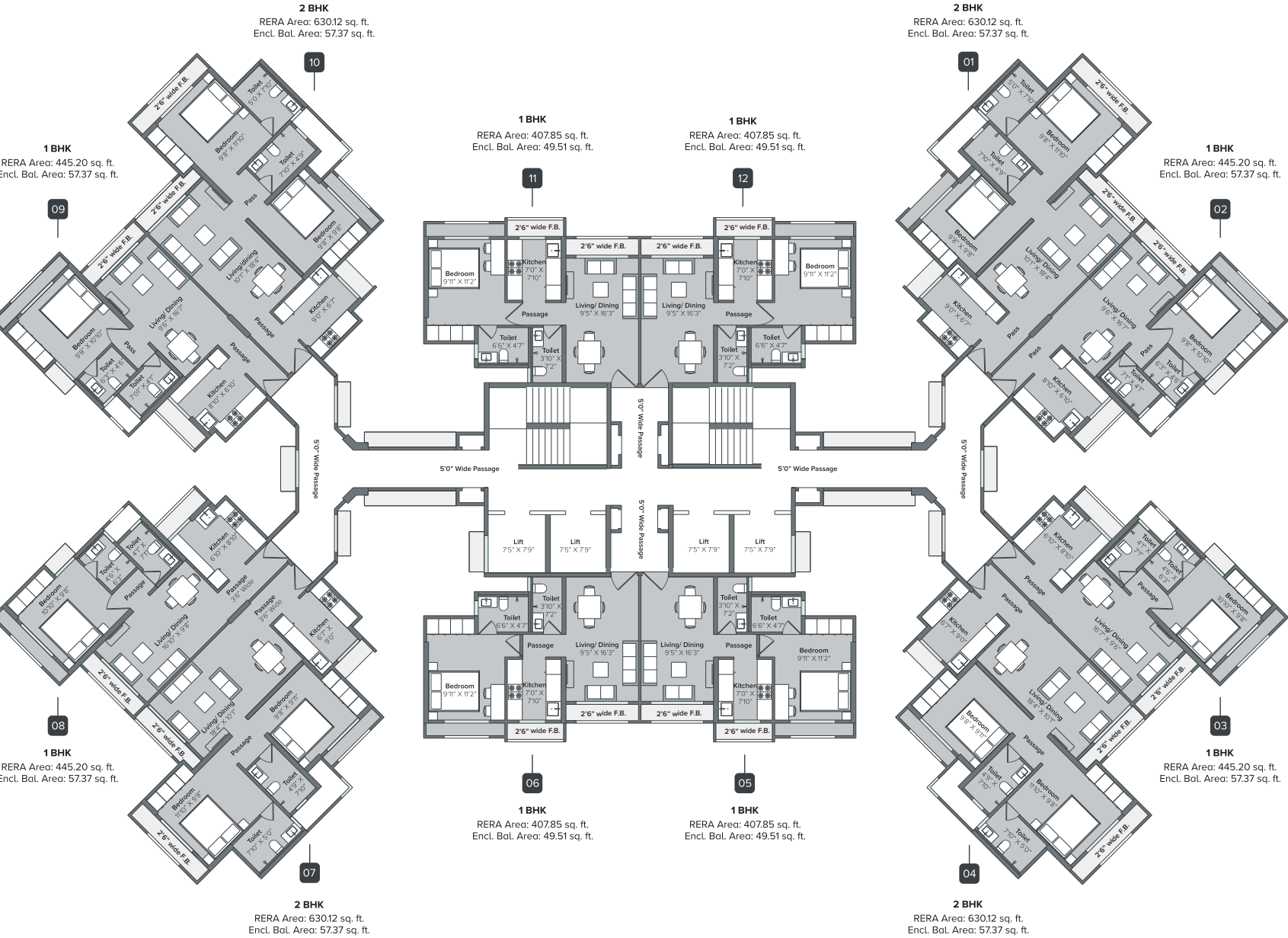

Floors 9, 12 & 17 are refuge floors and flat numbers 9 & 10 on each of these floors are not available for sale.

OPAL  
Floors 1st to 10th  
Typical Floor Plan



Flat No. 907 & 908 on 9th floor are refuge and not for sale

Disclaimer: The floor plans are as per the approved plans and specifications as of date. These plans may vary by +/- 3% and are subject to changes. The furniture, accessories, etc. shown in the plans does not form a part of the offering. Customers are requested to visit the site office and apprise themselves of all the necessary details prior to making any purchase decisions.



Topaz  
Floors 1st to 10th  
Typical Floor Plan

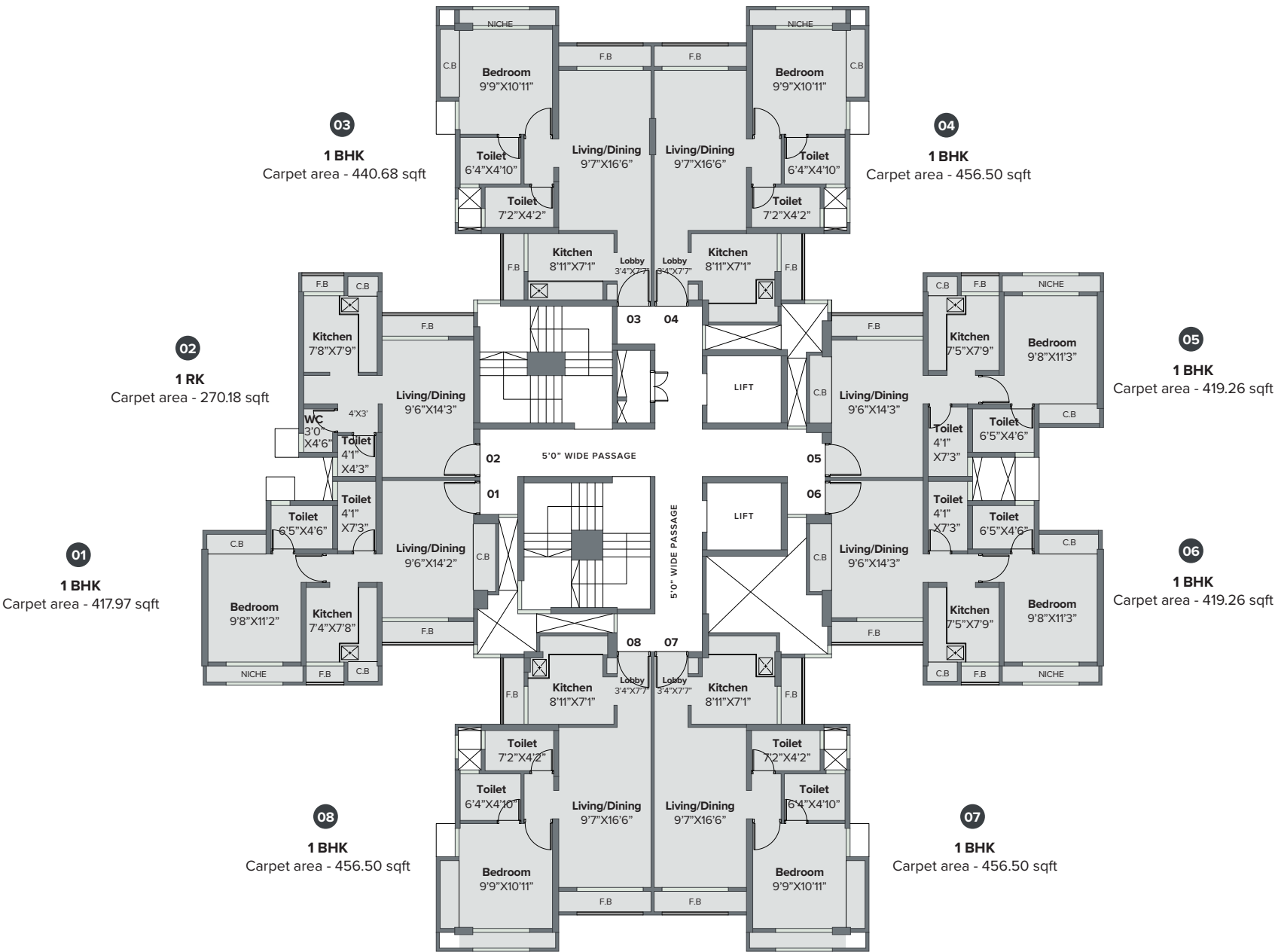

Disclaimer: The floor plans are as per the approved plans and specifications as of date. These plans may vary by +/- 3% and are subject to changes. The furniture, accessories, etc. shown in the plans does not form a part of the offering. Customers are requested to visit the site office and apprise themselves of all the necessary details prior to making any purchase decisions.

Flat No. 907 & 908 on 9th floor are refuge and not for sale

Amber  
Floors 1st to 10th  
Typical Floor Plan



Disclaimer: The floor plans are as per the approved plans and specifications as of date. These plans may vary by +/- 3% and are subject to changes. The furniture, accessories, etc. shown in the plans does not form a part of the offering. Customers are requested to visit the site office and apprise themselves of all the necessary details prior to making any purchase decisions.

Flat No. 907 & 908 on 9th floor are refuge and not for sale